

# KEENAN<sup>®</sup>

an **Alltech** company

Engineered and  
handcrafted in  
Ireland



**Driving global farm  
profits through  
precision nutrition**

# Green on the outside - even greener on the inside

Established in 1978, and a member of the Alltech family of companies since April 2016, KEENAN is a respected leader in sustainable and profitable farming solutions, focused on maximising feed efficiency. Over the course of more than four decades in business, KEENAN has earned a particularly strong reputation for manufacturing quality diet feeders, delivering unparalleled results on farms all over the world.

KEENAN prides itself on continuous investment into new technology for the benefit of its customers globally. The company has evolved throughout the years, combining cutting-edge technological developments with breakthrough nutritional expertise.

A keen advocate for environmental sustainability, KEENAN has developed a range of solutions to enable farmers to overcome agricultural production challenges and improve rumen health and feed efficiency.

These commitments were rubber stamped in 2019 when the Carbon Trust validated the KEENAN green machine. Having investigated the output from the KEENAN diet feeder and reviewing data from the KEENAN controller, the Carbon Trust established that the improved FCE (Feed Conversion Efficiency) with the KEENAN machine can reduce methane emissions on farm.

## About Alltech

Founded in 1980 by Irish entrepreneur and scientist Dr. Pearse Lyons, Alltech improves the health and performance of people, animals and plants through nutrition and scientific innovation. With nearly 100 manufacturing sites globally, Alltech is a leading producer and processor of yeast and organic trace minerals.

The company's guiding Planet of Plenty principle seeks to develop solutions that are safe for the Animal, Consumer and the Environment and is actively supported by close to 5,000 team members worldwide.

Headquartered just outside of Lexington, Kentucky, USA, Alltech has a strong presence in all regions of the world.

For further information, visit [www.alltech.com](http://www.alltech.com)



*KEENAN Factory, Borris,  
Co. Carlow, Ireland.*



*Alltech Corporate Headquarters,  
Lexington, Kentucky.*



# The MechFiber Difference

KEENAN machines are unique in the proven nutritional benefits they deliver. Each KEENAN is engineered to use a gentle mixing action to produce evenly, thoroughly mixed, light, fluffy feed which is never over or under mixed. We call this optimal mix 'MechFiber'. The KEENAN controller, which is synced with the InTouch feed management platform ensures all feed ingredients are consistently added in the same order and ratios.

Independent trials have consistently shown that MechFiber retains the fibre structure to stimulate rumination, allows greater absorption of energy and maximised feed conversion efficiency.

## Scientific Results - MechFiber Research

Numerous scientific studies\* have corroborated what KEENAN has known for decades - the MechFiber fed rumen is healthier and as a result animals are more productive.

RESEARCH MONITORING 24,450 DRY COWS ACROSS 277 FARMS SHOWED A REDUCTION IN THE FOLLOWING:



**THE MECHFIBER MIX - FORAGE WITH STRUCTURE AS NATURE INTENDED**

Professor Drackley of University of Illinois also found "*Substantial gains in animal health*" in the form of:

- More consistent intakes
- Less fluctuation in body condition
- Increased lactation persistency
- Less liver fat accumulation

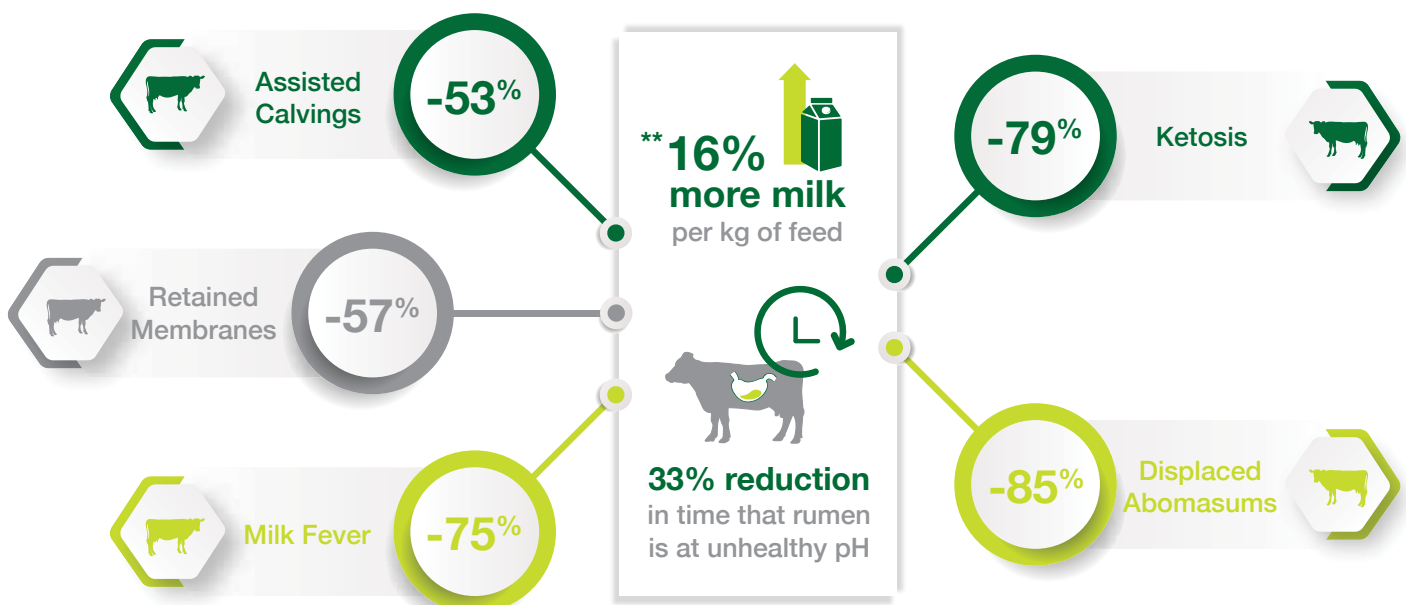

\* University of Illinois 2008, University of Reading 2008 & Colman et al, 2011. Professional Animal Scientist, 27, 505-17

\*\* "Subtle changes in rumen conditions had major effects on feed efficiency" Professor Jim Drackley

- Mixing chamber containing 6-paddle reel with fixed mounted knives at the bottom
- The paddles gently lift and tumble the added materials across the blades ensuring feedstuff is cut to an optimal length without destroying the quality of the fibre. This is to create a mix with the correct chop length and structure for optimum rumen health
- The two chambers are separated by an exit door which opens when the feed is mixed and ready to be fed out through the discharge chamber
- The auger is housed in the discharge chamber to evenly dispense feed to the animals. Traditional diet feeders house the auger inside the mixing chamber, which can lead to physical damage to the feed, compromising the mix quality
- KEENAN Controller is connected via the internet to our InTouch monitoring software. This records and communicates ingredient weights, diets, rotations, mixing speed and mixing accuracy. Our advisors monitor this information daily to safeguard against problems on-farm

## DISCHARGE CHAMBER



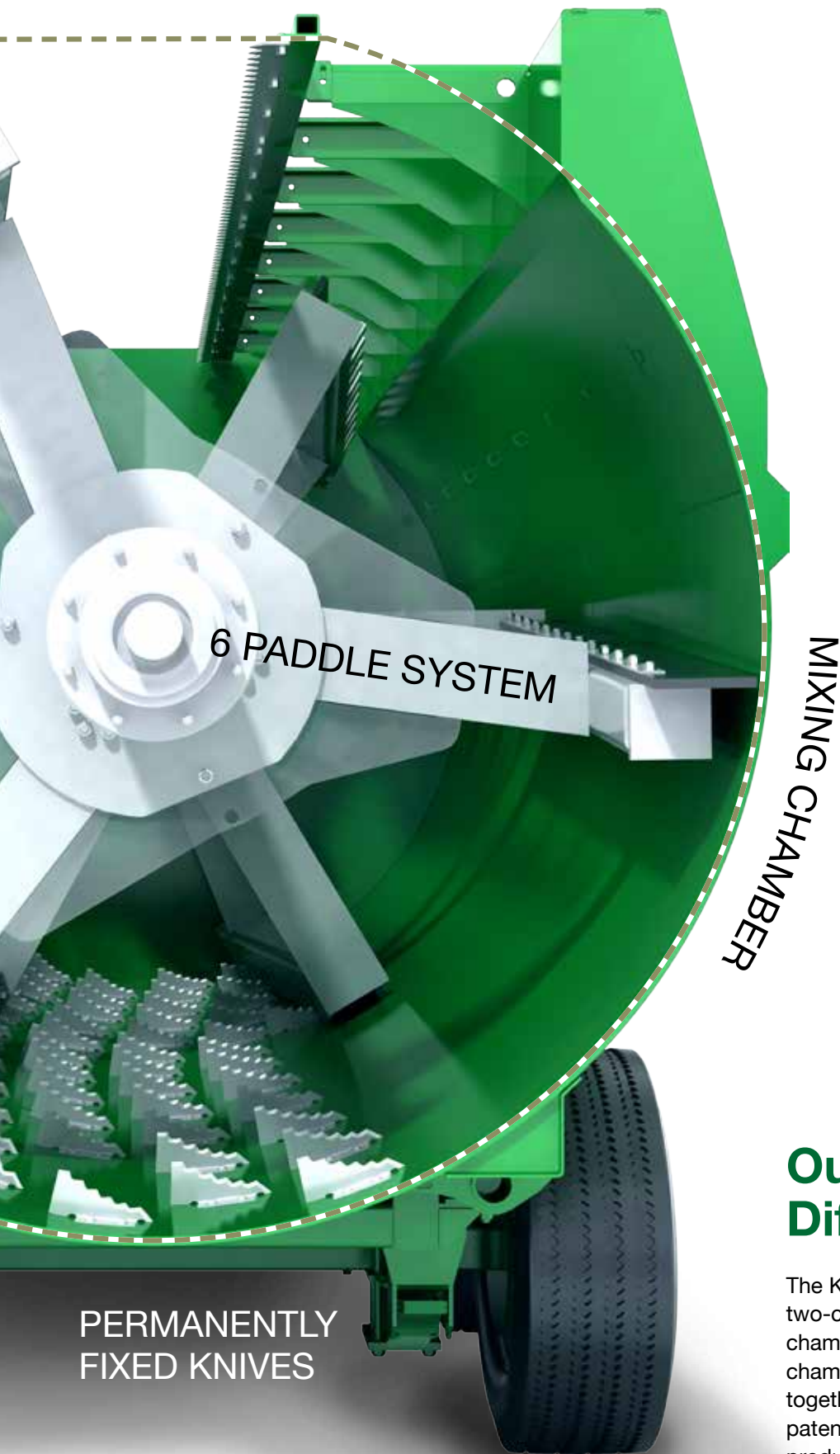

## Our Engineering Difference

The KEENAN diet feeder has a unique two-chamber system - both a mixing chamber and a separate discharge chamber. The two-chamber system, together with the 6-paddle reel and our patented fixed knives system is how we produce MechFiber - the open fluffy mix that is unique to KEENAN.

**A QUALITY OF MIX THAT  
BENEFITS BOTH YOU  
AND YOUR ANIMALS.**

# KEENAN Controller

The KEENAN controller is synced with the InTouch feed management platform; allowing farmers to easily measure, monitor and manage feed accuracy and efficiency, herd performance, feed costs, dry matter intake and refusals.

## KEENAN Controller:

- Gives clear instructions on order and weight of ingredients
- Leading to maximised ration quality and consistency

## Instant Revolutions & AutoStop:

- Prevents over or under mixing of feed ingredients
- Ensures a consistent TMR in every load
- Delivers a balanced ration with every bite of feed

## Automated Data Sharing:

- Ability to send ration changes straight from the InTouch feed management platform directly to the farmer
- Simplifies communication between the farmer, employees and trusted advisors
- Reduces time delays/labour in implementing ration changes

## InTouch Platform – A Real Time Performance Measuring & Support Service That:

- Monitors exact inclusion rates of ration ingredients
- Audits KEENAN feeder performance
- Measures daily feed efficiency and over 20+ key performance indicators



Helping thousands of farmers and animal nutritionists globally.



Feeding 300,000+ animals daily.



Detailed graphs and reports on ingredients used, feed costs, herd productivity and feeding accuracy.



Real time wireless transfer of animal diets and mixing revolutions.



Global presence - Call centres in Ireland, France and New Zealand.



Providing the farmer with control, accuracy and real-time feed advice.





Easily measure, monitor  
and manage your  
feed efficiency

## Benefits of using the KEENAN controller and InTouch feed management:

- Provides accurate feed advice and ration formulation
- Delivers consistency in both feed and mixing
- Improves milk yields and milk solids
- Assists in finishing cattle quicker
- Improves herd health
- Monitors and controls feed costs





## Global Spread of KEENAN Machines

IRELAND  
FRANCE  
UK  
DENMARK  
NORWAY  
SWEDEN  
GERMANY  
NETHERLANDS

BELGIUM  
SPAIN  
PORTUGAL  
ROMANIA  
BULGARIA  
HUNGARY  
CZECH REPUBLIC  
SWITZERLAND

SLOVENIA  
POLAND  
ESTONIA  
LATVIA  
MOROCCO  
CANADA  
USA  
MEXICO

VENEZUELA  
PERU  
CHILE  
ARGENTINA  
BRAZIL  
CHINA  
INDIA  
JAPAN





MALAYSIA  
INDONESIA  
AUSTRALIA  
NEW ZEALAND  
SOUTH AFRICA  
ZIMBABWE  
BOTSWANA  
KENYA

TURKEY  
RUSSIA  
ICELAND  
ZAMBIA  
LITHUANIA  
MALTA  
CYPRUS  
GREECE

FINLAND  
SRI LANKA  
PHILIPPINES  
SAUDI ARABIA  
UAE  
OMAN  
YEMEN  
COLOMBIA

MAURITIUS  
SENEGAL  
SURINAME  
SUDAN  
PAKISTAN  
NAMIBIA  
THAILAND  
AUSTRIA

HONDURAS  
LUXEMBOURG  
PAPUA NEW GUINEA  
SERBIA  
UGANDA

## Optional Extras - Customise Your KEENAN

MACHINES ARE BUILT TO ORDER,  
ALLOWING FOR CUSTOMISATION  
OF EACH MACHINE TO SUIT THE  
INDIVIDUAL NEEDS AND A VARIETY  
OF FARM SET-UPS.



### BALEBLEND

An optional extra for those who use a large proportion of baled forage in their farming operation. BaleBlend ensures a fast, even and consistent intake of round and square bales of all forage types.



### FEED-OUT

The feed-out method on the KEENAN machine can be adapted to suit various feeding systems. This means that it can be placed either to the front or to the rear of the machine. Double output to the rear of the machine is also possible if desired.

KEENAN machines are handcrafted using cutting edge technology in our world class manufacturing plant in Borris, Co. Carlow, Ireland. Each machine can be provided either as a trailed unit or as a stationary unit driven by an electric motor. Feeders come in a range of sizes from 8 cubic metres to 28 cubic metres. Our skilled team of welders and craftsmen undergo years of training to hone their skill - ensuring the well-earned reputation for quality and reliability of the KEENAN machine is upheld.



## CONVEYORS

Choose between different conveyors, either fixed or mobile, and with various lengths. The conveyors are also suitable for use with belt feeder systems.



## LINERS

Some customers opt to add either a hardened steel or plastic liner in the mixing chamber of the KEENAN. This liner gives the body of the machine a longer life.



## MAGNETS

Different options for the feed out tray are available - in particular, the tray can be provided with or without industrial-strength magnets.



## AXLES/WHEELS

KEENAN machines can be supplied with either single or twin axles. Axles can be spring mounted to absorb load impact. Wheel options can be varied subject to driving terrain and axle type.



# KEENAN®

## MechFiber Self-Propelled



- Consistently delivering the patented KEENAN MechFiber mix, with the capacity of 16m<sup>3</sup> to meet the requirements of farms of all sizes
- Heavy duty sealed oil bath drive system
- Featuring exclusive STORTI mechanical transmission reducing fuel consumption up to 25%



- Cutter head designed & tested to ensure protection of forage structure for optimum mix quality
- Ultimate in operator comfort and control with twin video cameras and in-cab monitor for visibility, climate control and pneumatic seat
- Reduced noise and running costs

The operating system of the KEENAN MechFiberSP range has been cleverly designed for ease of maintenance and features a mechanical drive to the six-paddle reel.

This exclusive engineering system, by means of a specially designed gearbox and PTO shaft, transfers all the power from the engine to the mixing system, thus reducing fuel consumption by up to 25% as well as reducing maintenance costs.



#### **Class-leading cutter head technology**

The cutter head used in the KEENAN MechFiber SP range has been engineered to deliver rapid loading of a vast number of products (grass silage, hay, waxy maize, pulp, pellets, flour, square or round bales of straw or hay, etc.) leaving a clean, uniform face for optimum pit face management.

The tungsten-coated blades feature a unique crossed arrangement, performing clean cuts without damaging the structure of the fibre, even with very compact silages.

#### **Speed. Precision. Versatility.**

The unique placement of the blades and configuration of the loading channel allows the cutter to load in both directions. High speed loading belt drastically reduces the preparation time.



# Proven Performance Benefits













Brand	Silage fiber destruction			Loading hay (large bale format)				Engine Rpm
	Average length from the silo (mm)	Average length from the inlet belt (mm)	Destruction (mm)	Destruction (%)	Load (400kg)	Time in "min"	Flow t/min	
Mutti	9	8.01	0.71	8.14%	415	7'33	55	2500
Faresin	9.3	8.2	1.1	11.83%	410	3'39	112	2000
Kuhn	9.74	8.67	1.07	10.99%	400	2'01	198	2500
Taarup Kverneland	8.89	8.08	0.81	9.11%	400	4'08	97	2000
Sgariboldi	9.4	8.7	0.7	7.45%	410	7'28	55	1800
Rmh	9.23	7.92	1.31	14.19%	410	1'50	224	1750
Storti	9.14	8.76	0.38	4.16%	420	1'15	336	1800

Extensive testing at INRA in France in 2012 has shown the Storti design of cutter head and loading arm outperformed the competition.

- 50 - 200% less silage fibre destruction
- Up to 6 times faster loading
- Highly efficient engine RPM



# MechFiber Machine Specification

		MACHINE	HEIGHT MM (INCHES)**	WIDTH MM (INCHES)	LENGTH (INCHES)
Page 12		MechFiber345SP	3,040 (120)	2,550 *** (100.5)	9,640 (380)
Page 18		MechFiber400	3,421 (134.5)	3,009 (118.5)	7,600 (299)
Page 19		MechFiber380	3,201 (126)	2,819 (111)	7,600 (299)
Page 20		MechFiber370	3,200 (126)	2,856 (112.5)	7,250 (285.5)
Page 21		MechFiber365	3,020 (119)	2,665 (105)	7,250 (285.5)
Page 22		MechFiber350	3,112 (122.5)	2,856 (112.5)	6,250 (246)
Page 23		MechFiber345	2,932 (115.5)	2,619 (103)	6,250 (246)
Page 24		MechFiber320	2,805 (110.5)	2,541 (100)	6,250 (246)
Page 25		MechFiber300	2,660 (104.5)	2,482 (97.5)	6,250 (246)
Page 26		MechFiber280	2,563 (101)	2,380 (93.5)	6,250 (246)
Page 27		MechFiber270	2,694 (106)	2,541 (100)	4,850 (191)
Page 28		MechFiber250	2,523 (99.5)	2,380 (93.5)	4,850 (191)

\*Payload = Maximum design payload. Number of animals/load is dependent on ration composition & dry matter of materials being loaded.  
 \*\*Height and width will vary depending on axle/tyre combinations and optional extra selection, please contact your local KEENAN representative to ensure correct machine is chosen to suit your farm layout.

MM	PAYLOAD KG (LB)*	MIX CAPACITY M <sup>3</sup> (FT <sup>3</sup> )	HORSEPOWER	MILKING COWS/LOAD	BEEF FINISHERS/LOAD
	6,000 (13,225)	16 (565)	170	65-100	130-200
	10,000 (22,045)	28 (990)	120	140 - 200	300 - 400
	9,000 (19,840)	24 (848)	115	120 - 170	240 - 320
	8,000 (17,635)	20 (706)	105	100 - 140	200 - 280
	8,000 (17,635)	20 (706)	105	100 - 140	200 - 280
	5,500 (12,125)	17 (600)	90	85 - 120	170 - 220
	6,000 (13,225)	16 (565)	90	65 - 100	130 - 200
	3,800 (8,378)	14 (494)	80	55 - 85	110 - 170
	3,800 (8,378)	12 (424)	80	48 - 72	96 - 144
	2,750 (6,750)	11.5 (406)	70	50 - 60	100 - 120
	3,000 (6,615)	10 (353)	70	40 - 60	80 - 120
	2,500 (5,510)	8 (283)	55	30 - 50	60 - 100

\*\*\*MechFiber345SP Machine Width increases to 2590mm if optional side mounted ladder is fitted.



# KEENAN<sup>®</sup>

## MechFiber400



The largest paddle diet feeder in the KEENAN range, the KEENAN MechFiber400 sets new standards for mixing. Its heavy duty four chain drive system allows for high work rates, durability and trouble free operation. The heavy duty chassis with spring mounted drawbar is designed to improve weight transference and stability when driving.

# KEENAN® MechFiber380



The KEENAN MechFiber380 is designed for the farmer who wants to feed large numbers of animals in a short period of time. Aesthetically closer to the KEENAN MechFiber400, it retains the manoeuvrability of the smaller KEENAN MechFiber365. The two front doors ensure easy access to the sealed oil-bath unit for maintenance.



# KEENAN<sup>®</sup>

## MechFiber370



The KEENAN MechFiber370 is the ideal machine for the farmer who requires a highly manoeuvrable machine with high capacity. The wide mixing chamber encourages greater tumbling of feed during mixing which helps keep power requirement low. Like all KEENAN diet feeders, it will produce the same high quality MechFiber ration with 500kgs as at full capacity.



# KEENAN®

## MechFiber365



The KEENAN MechFiber365 is the first machine of the medium sized range to be designed with a heavy duty sealed oil-bath drive system. The two chain driveline is self-lubricating, reducing the loading on the chains and sprockets and increasing their working life. A central greasing manifold allows all front bearings to be greased from one location.

# KEENAN® MechFiber350



The design of the KEENAN MechFiber350 makes it the perfect mid-range machine for incorporating high levels of dense fibrous material into diets. The wide mixing chamber creates more space for the gentle tumbling action that produces the KEENAN MechFiber ration consistently. This high volume machine is capable of discharging feed over barriers 1,346mm (53") high.

# KEENAN®

## MechFiber345



The KEENAN MechFiber345 has a similar footprint to the KEENAN MechFiber320, offering a bigger mixing capacity (up to 35% greater) and featuring an enlarged mixing chamber. It features an oil bath driveline with automatic chain lubrication system for easy maintenance and central greasing of all front bearings from one location.

- Self-lubricating two-chain driveline
  - Reducing loading on chains & sprockets
  - Increases their working life



# KEENAN® MechFiber320



The KEENAN MechFiber320 is one of the most popular models in the KEENAN range. It is a highly versatile machine and adaptable to most feeding operations. Like all KEENAN diet feeders, it will produce as high a quality MechFiber ration with 500kgs as at full capacity. The machine can discharge over 1,181mm (46.5") without additional modifications.

# KEENAN<sup>®</sup>

## MechFiber300



The KEENAN MechFiber300 is the perfect machine for the medium sized operator with limited space. Its narrow footprint comes from a smaller diameter discharge auger located lower on the side of the machine. The front driveline includes an auxiliary drive shaft more evenly distributing the input power requirement of the machine.



# KEENAN<sup>®</sup>

## MechFiber280



The KEENAN MechFiber280 is designed with a low overall height and narrow footprint. It is ideally suited to farms where space is limited. The gentle paddle mixing action produces a consistent ration while maintaining the important quality KEENAN MechFiber ration structure.



# KEENAN® MechFiber270



Also from the smaller range of KEENAN feeders, the KEENAN MechFiber270 affords greater flexibility around the farm. With a build similar to some medium size range diet feeders allows for the addition of BaleBlend technology if required. It can offer a discharge height to feed over barriers of up to 1,070mm (42") without any extra modifications.

# KEENAN<sup>®</sup>

## MechFiber250



The KEENAN MechFiber250 is the smallest six paddle machine in the range. With an overall height from as little as 2,328mm (91.5"), this is an ideal machine for smaller farms. As with all KEENAN machines, the simple two-chain drive system and externally mounted bearings ensure a low maintenance machine.







## NEW VERTICAL MODELS

KEENAN have always been proponents of the unique quality of the MechFiber mix produced by our paddle diet feeders. However, in Italian manufacturer Storti we have found the best vertical machine in the market and have successfully enhanced the output from this machine with the addition of our InTouch technology. These machines are ideally suited for the farmer who is looking for extra capacity – but within a small footprint.

These vertical auger machines do not produce the patented MechFiber mix: however, the nutritional output they can now produce has been greatly optimised thanks to implementing our unique algorithms for the exact mixing order, speed and rotations

## InTouch Algorithm + Nutrition Advice

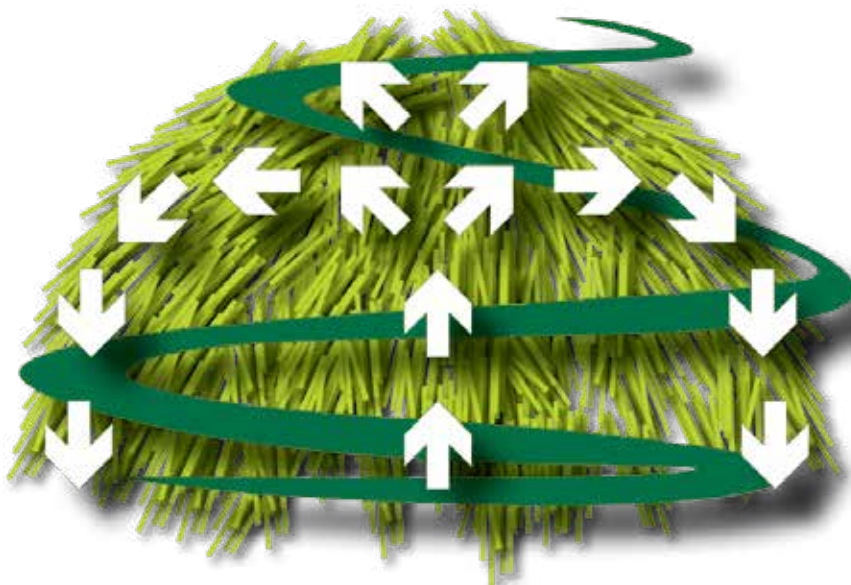

The vertical models uphold the KEENAN values of machine reliability as well as low power and maintenance requirements. Engineered to optimise the use of space, the KEENAN VA2 and KEENAN VA3 machines allow materials to be rapidly and efficiently mixed into the overall total mixed ration.





### SPEED

Materials are rapidly and efficiently mixed into the overall TMR

### CAPACITY

Efficient use of space to maximise capacity

### FOOTPRINT AND HANDLING

Extremely manoeuvrable. Small footprint allowing access to most farmyard buildings

### HEAVY DUTY CHASSIS

Mounted on custom-built heavy duty chassis to ensure durability under the toughest conditions

### SPRINT PADDLES

Sprint paddles help to speed up feed-out. One is fitted to each auger ensuring a constant rate of discharge of material.

### HEAVY DUTY AUGER AND BLADES

Fitted with heavy duty augers as standard. Triangular blades fitted with tungsten coating to increase longevity

### TWO-SPEED GEARBOX

The two-speed gearbox means that using low speed the power requirement from the tractor to start up a load is greatly reduced; while high speed can be used to ensure rapid, even emptying.



## KEENAN VA2-18, KEENAN VA2-21, KEENAN VA2-24S

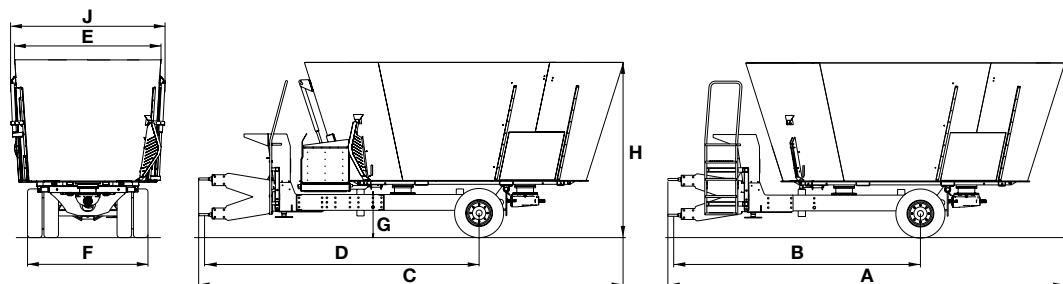

		A	B	C	D	E	F	G	H	I	J	Required Power**	Empty Weight**	Full Load Weight
	m <sup>3</sup>	mm	mm	mm	mm	mm	mm	mm	mm	mm	mm	kW-HP	kg	kg
KEENAN VA2-18	18	6,960	4,480	7,430	4,850	2,440	2,025	800	2,980	2,900	2,570	81	6,060	12,600
KEENAN VA2-21	21	7,120	4,480	7,760	5,010	2,450	2,180	875	3,160	3,080	2,590	90	7,100	16,000
KEENAN VA2-24S	24	7,180	4,080	7,820	4,720	2,480	2,180	875	3,320	3,320	2,590	100	7,720	16,000

## KEENAN VA2-24L, KEENAN VA2-27, KEENAN VA2-30, KEENAN VA2-33

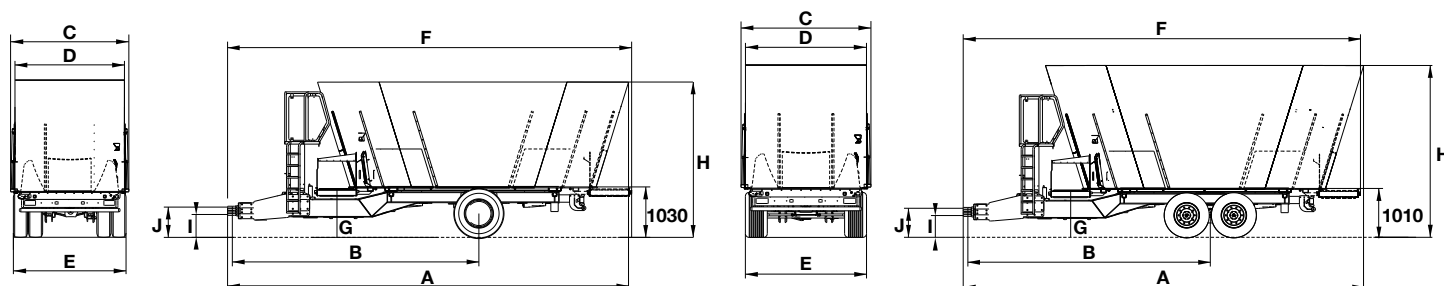

		A	B	C	D	E	F	G	H	I	J	Required Power*	Empty Weight**	Full Load Weight
	m <sup>3</sup>	mm	mm	mm	mm	mm	mm	mm	mm	mm	mm	kW-HP	kg	kg
KEENAN VA2-24L	24	8,360	5,330	2,700	2,500	2,510	8,360	820	2,940	465	610	120	9,950	17,500
KEENAN VA2-27	27	8,430	5,330	2,700	2,500	2,510	8,430	820	3,150	465	610	130	10,150	17,500
KEENAN VA2-30	30	8,490	5,330	2,700	2,500	2,510	8,490	810	3,330	450	600	140	10,750	22,500
KEENAN VA2-33	33	8,560	5,330	2,700	2,500	2,510	8,560	810	3,560	450	600	150	11,000	22,500

## KEENAN VA3-36, KEENAN VA3-40, KEENAN VA3-44

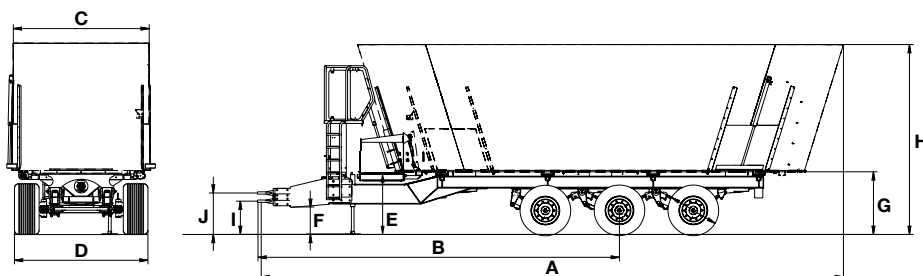

		A	B	C	D	E	F	G	H	I	J	Required Power*	Empty Weight**	Full Load Weight
	m <sup>3</sup>	mm	mm	mm	mm	mm	mm	mm	mm	mm	mm	kW-HP	kg	kg
KEENAN VA3-36	36	10,580	6,650	2,500	2,510	1,110	500	1,150	3,100	610	760	210	16,200	32,500
KEENAN VA3-40	40	10,650	6,650	2,500	2,510	1,110	500	1,150	3,310	610	760	210	16,450	32,500
KEENAN VA3-44	44	10,700	6,650	2,500	2,510	1,110	500	1,150	3,490	610	760	210	16,700	32,500

\*Power requirement dependent on loaded products.

\*\*Approximate weight. Actual weight subject to options fitted to the machine.

# KEENAN®

## VA2-18



The KEENAN VA2-18 is the smallest machine in the KEENAN VA range. With a lower footprint, the KEENAN VA2-18 affords greater mobility. The tank, augers and components of the KEENAN VA2-18 are manufactured using the same quality, strength and thickness of steel as the larger machines in the KEENAN VA range.

# KEENAN®

## VA-24S



The VA2-24S is the shorter option in the KEENAN VA 24m<sup>3</sup> range and is ideally suited for situations where space is limited and mobility is of prime importance. As with all machines of the KEENAN VA range, it comes with InTouch as standard to optimise the mix through implementing our unique algorithms for the exact mixing order, speed and number of rotations per load.



# KEENAN<sup>®</sup>

## VA2-24L



The KEENAN VA2-24L is the longer option in the KEENAN VA 24m<sup>3</sup> range of machines. The KEENAN VA2-24L is mounted on a heavy-duty chassis and features a robust gear box. This machine has a lower profile than the VA2-24S, giving the ability to be used on farms with height restrictions.

# KEENAN®

## VA2-30



The KEENAN VA2-30 is a heavy-duty machine with the capacity to feed large herds quickly. Multiple feed-out options to suit a variety of feeding situations are available across the full range of the KEENAN VA machines.

# KEENAN®

## VA3

The KEENAN VA3 range has three different models, ranging in size from 36 - 44 cubic metres.

This range of vertical feeders are longer and narrower than their VA2 counterparts, and come with a range of feedout options. All machines in the KEENAN VA3 range are supplied with the InTouch controller as standard, guaranteeing an optimal TMR through precise loading and mixing times.







# KEENAN® ProMix

The KEENAN ProMix is an industrial machine developed for high throughput industrial applications. It incorporates patented mixing, management and control technologies. Preserving the original KEENAN philosophy of simplicity in design and ease of use and maintenance, the KEENAN ProMix has the flexibility to be built for multiple applications.









# KEENAN<sup>®</sup> OrbitalSpreader

The KEENAN OrbitalSpreader is a heavy duty versatile muck spreader. It is capable of high work rates, with trouble free spreading of a wide range of farm and commercial wastes. It delivers a uniform spread pattern up to 20 meters wide. Material is pushed to the front for discharge ensuring better weight transfer minimising soil compaction.



# KEENAN Accredited Service and Genuine Spare Parts

## Accredited Service Centres

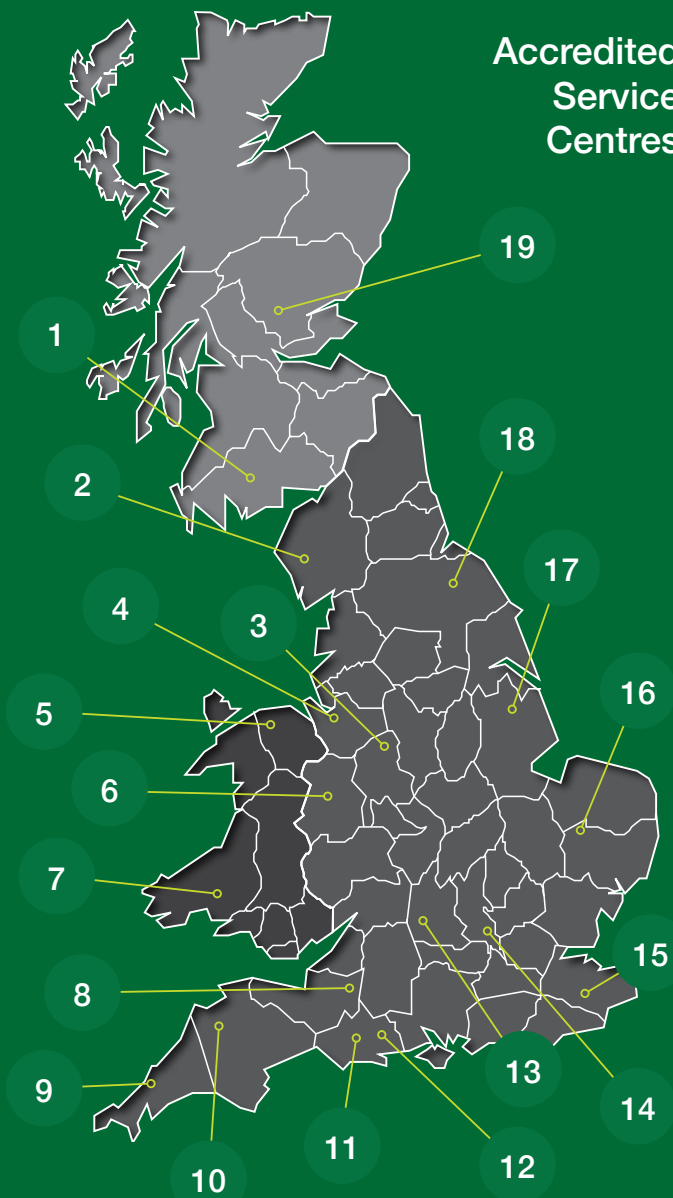

## Why KEENAN Accredited Service?

No one knows more about your machines than our skilled KEENAN service engineers. We are committed to ensuring that you are 100% satisfied with your KEENAN machine at the point of purchase and any day after – our established KEENAN network is there to help.

## Why KEENAN Genuine Spare Parts?

Only KEENAN genuine spare parts are used by our KEENAN engineers. These are specifically designed for KEENAN - and are tried and tested, having stood the test of time in all of our KEENAN machines worldwide. Ensuring maximum reliability and delivery of the proven nutritional benefits that are associated with a KEENAN.

## We are here to help

Our sales, aftersales and parts centre provide you with the very best products, service, advice and customer care. Get in touch to ensure your machine will give you a long, trouble-free life and retains its re-sale value. We provide a 24-hour emergency machine back-up service 365 days per year.



KEENAN Genuine Spare Parts



Service support



KEENAN-trained Service Engineers

**24 hours service,  
365 days per year**

**NEVER MISS A FEED!**

**1. John Halliday & Sons**  
01557 870200

**2. Peter Woodhouse**  
01229 718359  
07860 506166

**3. Johnsons of Cheadle**  
01538 756272

**4. Stamford Agri Services**  
01829 771509

**5. Harrison Machinery**  
01824 707003

**6. H.F. Evans & Son**  
07855 142401

**7. Anthony James**  
07929 353230

**8. Smart Ag Services**  
Cheddar: 01934 741166  
Bridgewater: 01278 733603

**9. Tom Wills**  
07753 566162

**10. Blakewell Services LTD**  
Branstaple: 01271 375947  
Hatherly: 01837 811050

**11. Francis Bugler Ltd**  
Beaminstor: 01308 862239  
Axminster: 01297 34319

**12. C. J. Cox**  
01258 473176

**13. Ian Cox**  
07711 220656

**14. KEENAN Central Spares**  
02476 995 694

**15. J.D. Mills Engineering**  
01233 756660  
07860 809298

**16. Cranworth Farm Services**  
01362 820391

**17. Recycling Equipment Services Ltd**  
01158 700507

**18. Ross McTurk Agricultural Engineers**  
07905 327755  
01845 537448

**19. Tam Shilliday**  
07813 532320

Alltech Farming Solutions (UK) Ltd  
Ryhall Road Stamford PE9 1TZ  
**Tel: +44 (0)1780 437521**  
**Email: [keenaninfo@alltech.com](mailto:keenaninfo@alltech.com)**

**KEENAN<sup>®</sup>**  
an **Alltech<sup>®</sup>** company

[keenansystem.com](http://keenansystem.com)

 @KEENANGlobal

 @KEENANsystem